

SETUP INSTRUCTIONS 2008

1190 RC8 EU

1190 RC8 AUS/UK

1190 RC8 FR

1190 RC8 JP

ART. NO. 3211398en



KTM

The work described in these setup instructions must be performed before the vehicle is delivered to the customer.

Read the setup instructions in their entirety before beginning work.

Print out the current **PDI** form found on the **KTM DEALER.NET**.

These setup instructions were written to correspond to the latest state of this series. We reserve the right to make changes in the interest of technical advancement without at the same time updating this manual.

We shall not provide a description of general workshop methods. Likewise, safety rules that apply in a workshop are not specified here. It is assumed that the work will be performed by a fully trained mechanic.

All specifications are non-binding. KTM Sportmotorcycle AG in particular reserves the right to modify or delete technical specifications, prices, colors, forms, materials, services, designs, equipment, etc., without prior notice and without specifying reasons, to adapt these to local conditions, as well as to stop production of a particular model without prior notice. KTM accepts no liability for delivery options, deviations from illustrations and descriptions, as well as misprints and other errors. The models portrayed may contain special equipment that does not belong to the regular scope of delivery.

© 2008 by KTM-Sportmotorcycle AG, Mattighofen Austria

All rights reserved

Reproduction, even in part, is permitted only with the express written permission of the copyright owner.



REG.NO. 12 100 6061

ISO 9001(12 100 6061)

Within the meaning of the international quality management standard ISO 9001, KTM uses quality assurance processes that lead to the maximum possible quality of the products.

Issued by: TÜV Management Service

KTM-Sportmotorcycle AG
5230 Mattighofen, Austria

Symbols used

The following explains the meaning of specific symbols.



Identifies an expected reaction (e.g., of an operation or a function).



Identifies an unexpected reaction (e.g., of an operation or a function).



Identifies a page reference (more information is provided on the specified page).

Formats used

The type formats used are explained here.

Specific name	Identifies a name.
Name[®]	Identifies a protected name.
Brand[™]	Identifies a trademark.

Unpacking and setting up the vehicle

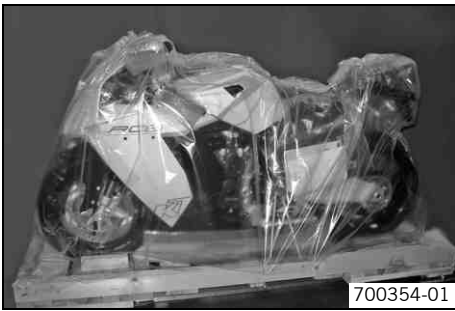

- Remove the cardboard packing material.
- Remove the adhesive tape at the top of the motorcycle.



- Roll down the plastic sheeting on the sides.



Info

To avoid damaging the motorcycle while unpacking it, leave the remaining plastic sheeting on the motorcycle until you have finished.

- Remove the separate enclosure from the seat.
- Unpack the separate enclosure and check its contents on the basis of the enclosure list.
- Check the vehicle for transport damage.
- Remove plastic ❶ from the handlebar stubs.
- Remove screw ❷ with distance sleeve ❸ from both handlebar stubs.
- Adjust the handlebar height. (☛ p. 5)

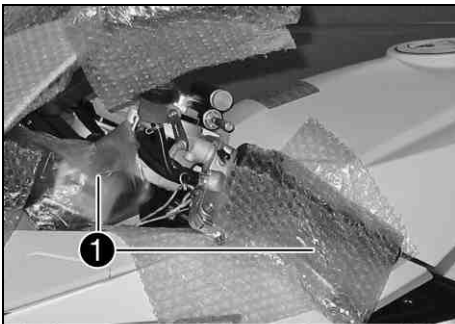

Info

Mount the handlebar stubs in the low position.

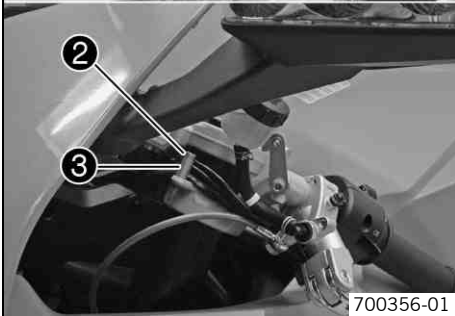

- Remove the side screws ❹ on the left holder.
- Remove the top screws ❺ on the left holder.
- Loosen the holder from the base frame in an upward direction.

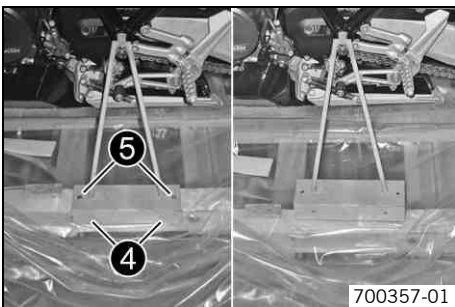

- Remove the side screws ❻ on the right holder.
- Remove the top screws ❼ on the right holder.
- Leave the holder on the base frame.



Info

The motorcycle is leaning toward the right and is resting against the holder on the base frame.

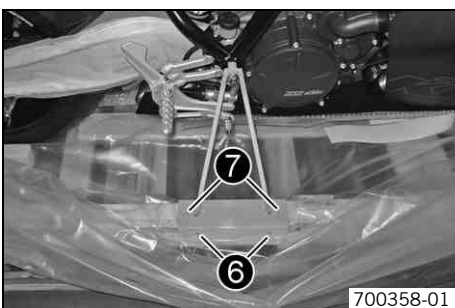

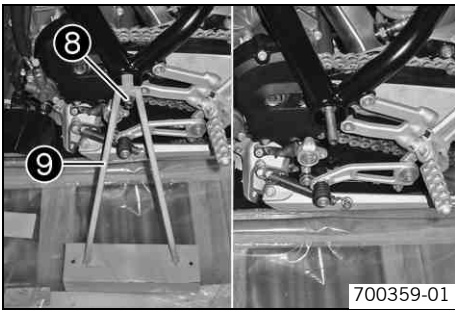

700359-01

- Remove nut 8 on the left holder.
- Remove the left holder.



Info

The threaded stud is no longer fixed on the left side.



700360-01

- With the assistance of another person, stand the motorcycle upright.
- Remove the right holder with the nut and threaded stud toward the side.
- Push the motorcycle off of the pallet.
- Remove the remaining plastic sheeting.



700217-01

- Mount the reflector.

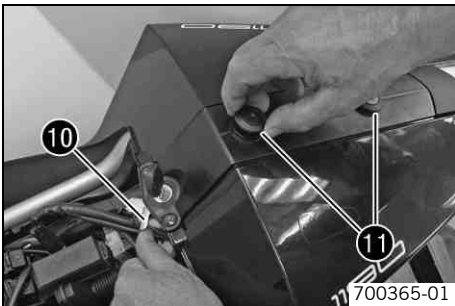

700365-01

- Remove the seat. (☛ p. 6)
- Activate lever 10.
- Remove locking caps 11.
- Fit the passenger seat. (☛ p. 6)
- Recharge the battery. (☛ p. 6)
- Stow away the tool set under the seat.
- Fit the seat. (☛ p. 6)

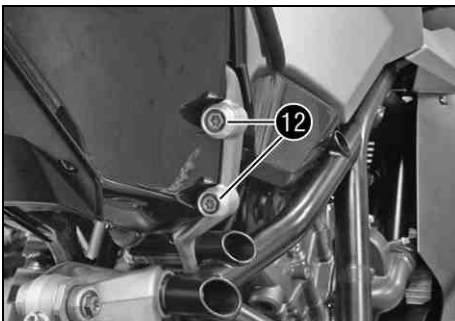

700366-01

- Remove screws 12 and bushings on the left and right sides of the vehicle.
- Mount the passenger footrests on the left and right sides of the vehicle using the screws from the separate enclosure.

Guideline

Screw, rear footrest bracket	M8	25 Nm (18.4 lbf ft)
------------------------------	----	------------------------

- Fill up with fuel. (☛ p. 7)
- Set kilometers/miles **SET KM/MILES**. (☛ p. 8)
- Set the clock with **SET CLOCK**. (☛ p. 8)
- Print out the current **PDI** form found on **KTM DEALER.NET** and perform the delivery inspection.

Adjusting the handlebar height

i Info
The handlebar stub position must be identical on the left and right of the vehicle.

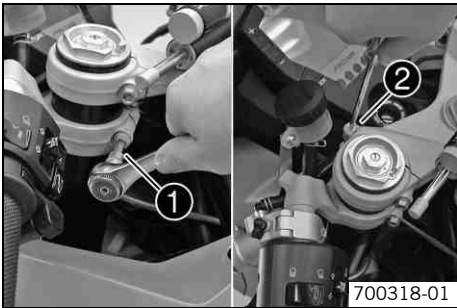

700318-01

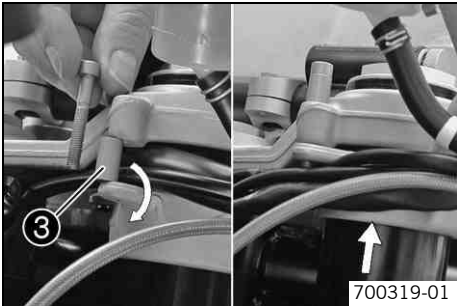

700319-01



700320-01



700320-11

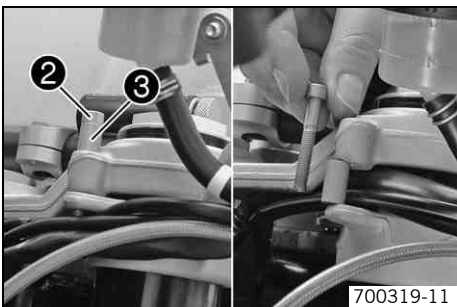

700319-11

Adjusting the high position of the handlebar stubs:

- Loosen screw ①.

i Info
Loosen the screw several turns to prevent damage to the fork lacquer when moving the handlebar stub.

- Remove screw ②.

- Remove distance sleeve ③.
- All cables routed under the upper triple clamp must now be routed under the handlebar stub.
- Push the handlebar stub carefully up to the upper triple clamp.
- Position the distance sleeve above the triple clamp.
- Mount and tighten the screw.

Guideline

Remaining chassis screws	M5	5 Nm (3.7 lbf ft)
--------------------------	----	-------------------

- Tighten the screw.

Guideline

Screw, handlebar stub	M8	20 Nm (14.8 lbf ft)
-----------------------	----	---------------------

- Repeat the adjustments on the other handlebar stub.
- Move the handlebar to and fro over the entire steering range.
 - » If the cables restrict the freedom of movement of the steering:
 - Correct the cable routing.

Adjusting the low position of the handlebar stubs:

- Loosen screw ①.

i Info
Loosen the screw several turns to prevent damage to the fork lacquer when moving the handlebar stub.

- Remove screw ② with distance sleeve ③.
- Carefully shift the handlebar stub by the length of the distance sleeve.

Guideline

Long distance sleeve	15 mm (0.59 in)
----------------------	-----------------

- Lay all cables between the upper triple clamp and the handlebar stub.
- Position the distance sleeves.
- Mount and tighten the screw.

Guideline

Remaining chassis screws	M5	5 Nm (3.7 lbf ft)
--------------------------	----	-------------------



- Tighten the screw.

Guideline

Screw, handlebar stub	M8	20 Nm (14.8 lbf ft)
-----------------------	----	------------------------

- Repeat the adjustments on the other handlebar stub.
- Move the handlebar to and fro over the entire steering range.
 - » If the cables restrict the freedom of movement of the steering:
 - Correct the cable routing.

Removing the seat



- Insert the ignition key in the seat lock ❶ and turn it anticlockwise.
- Raise the rear of the seat, push it towards the rear, and remove it upwards.

Fitting the passenger seat



- Position the passenger seat in the space provided.
- Press down the passenger seat until it clicks into place.
- Finally, check that the passenger seat is correctly mounted.

Fitting the seat

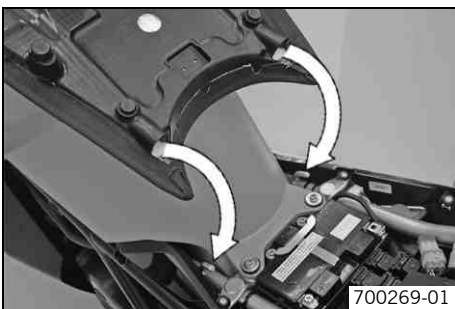

- Position the recesses of the seat to the lugs on the frame, lower the rear end and simultaneously push it forward.
- Lock the seat by turning the ignition key in the seat lock.
- Remove the ignition key from the seat lock.
- Finally, check that the seat is correctly mounted.

Recharging the battery



Warning

Risk of injury Battery acid and battery gases cause serious chemical burns.

- Keep batteries out of the reach of children.
- Wear suitable protective clothing and goggles.
- Avoid contact with battery acid and battery gases.
- Keep the battery away from sparks or open fire. Charge only in well-ventilated rooms.
- In the event of skin contact, rinse with large amounts of water. If battery acid gets in the eyes, rinse with water for at least 15 minutes and contact a physician.



Warning

Environmental hazard Components and battery acid are a danger to the environment.

- Do not dispose of batteries in normal household waste. Take defective or used batteries to a battery recycling operator.



Warning

Environmental hazard Problem materials cause environmental damage.

- Dispose of oil, grease, filters, fuel, cleaning substances, brake fluid, batteries, etc. according to regulations.



Info

Even if there is no load on the battery, it loses power every day. The charge state and the type of charge are very important for the service life of the battery. Fast recharging with a high charge current shortens the battery's service life. If the charge current, the charge voltage and the charge time are exceeded, electrolyte escapes through the breathing holes. The battery capacity is then reduced. If the battery becomes discharged from starting, it must be recharged immediately. If the battery rests for an extended time in a discharged state, it becomes over-discharged and sulfated, which will result in its destruction. The battery is maintenance-free, i.e., the acid level does not have to be checked.

- Switch off all power-consuming components and switch off the engine.
- Remove the seat. (☛ p. 6)
- Disconnect the negative (minus) cable of the battery to prevent damage to the vehicle's electronics.
- Connect the battery charger to the battery. Switch on the battery charger.

Battery charger (58429074000)

You can also use the battery charger to test rest potential and start potential of the battery, and to test the generator. With this device, you cannot overcharge the battery.

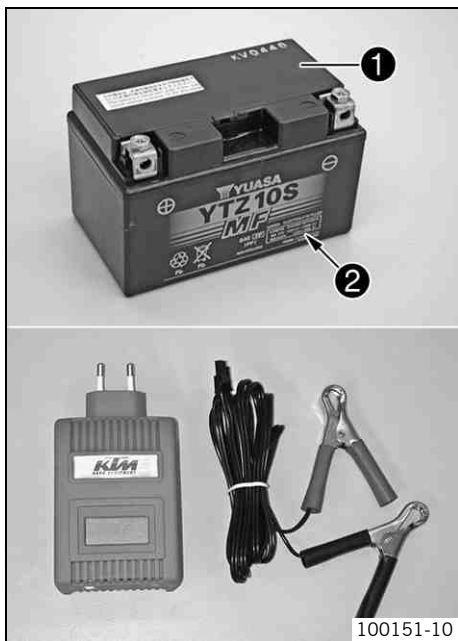

Info

Never remove the lid ❶.
Charge the battery according to the instructions ❷ on the battery casing.

- After charging the battery, switch off the battery charger. Reconnect the battery.
- Guideline

The charge current, charge voltage and charge time must not be exceeded.

Charge the battery regularly when the motorcycle is not in use.	3 months
---	----------

- Fit the seat. (☛ p. 6)

Refueling



Danger

Fire hazard Fuel can easily catch fire.

- Never fill up the vehicle near open flames or burning cigarettes, and always switch off the engine first. Be careful that no fuel is spilt, especially on hot vehicle components. Clean up spilt fuel immediately.
- Fuel in the fuel tank expands when warm and can escape if the tank is overfilled. See specifications on filling up with fuel.



Warning

Danger of poisoning Fuel is poisonous and a health hazard.

- Avoid contact between fuel and skin, eyes and clothing. Do not inhale fuel vapors. If fuel gets into your eyes, rinse immediately with water and contact a doctor. Wash affected skin areas immediately with soap and water. If fuel is swallowed, contact a doctor immediately. Change clothing that has come into contact with fuel.



Warning

Environmental hazard Improper handling of fuel is a danger to the environment.

- Do not allow fuel to get into the ground water, the ground, or the sewage system.

i **Info**

This motorcycle is equipped with a regulated catalyst. Leaded fuel will destroy the catalyst. You should therefore use unleaded fuel only.

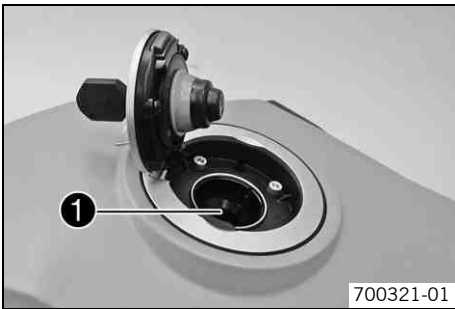

700321-01

- Switch off engine.
- Open the filler cap.
- Fill the fuel tank with fuel up to the lower edge ❶ of the fuel filler.

Total fuel tank capacity, approx.	16.5 l (4.36 US gal)	Super unleaded (ROZ 95 / RON 95 / PON 91) (☛ p. 11)
-----------------------------------	-------------------------	---

- Close the filler cap.

Setting kilometers/miles SET KM/MILES

i **Info**

Making a country-specific setting.

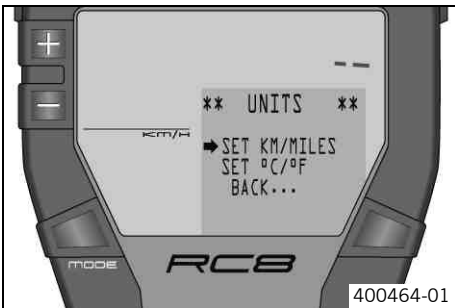

400464-01

Condition

The ignition is on.
The motorcycle is standing.

- Press the button and the button for 3 - 5 seconds.
- Press the button three times until the symbol is on **UNITS** in the info display.
- Press the button or the button briefly and repeatedly until the symbol is on **SET KM/MILES** in the info display.
- Press the **MODE** button briefly.
 - ✓ The selected unit appears on the left of the display.
- Select the unit with the button or the button .
- Press the **MODE** button briefly.
 - ✓ The settings are stored and the display changes to the **UNITS** menu.
- Press the button briefly and repeatedly until the symbol is on **BACK...** in the info display.
- Press the **MODE** button briefly.
- Press the button briefly and repeatedly until the symbol is on **EXIT SETUP** in the info display.
- Press the **MODE** button briefly.

Setting the clock with SET CLOCK

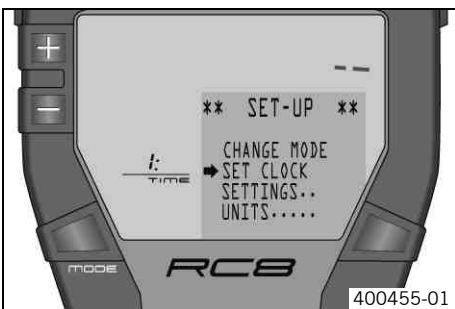

400455-01

Condition

The ignition is on.
The motorcycle is standing.

- Press the button and the button for 3 - 5 seconds.
- Press the button once until the symbol is on **SET CLOCK** in the info display.
- Press the **MODE** button briefly.
 - ✓ The hour is shown.
- Set the hour with the button or the button .
- Press the **MODE** button briefly.
 - ✓ The minutes are shown.
- Set the minutes with the button or the button .
- Press the **MODE** button briefly.
 - ✓ The settings are stored and the display changes to the **SET-UP** menu.
- Press the button briefly and repeatedly until the symbol is on **EXIT SETUP** in the info display.
- Press the **MODE** button briefly.

TECHNICAL DATA - CHASSIS TIGHTENING TORQUES

Screw, side stand switch	M4	2 Nm (1.5 lbf ft)	Loctite® 243™
Screw, brake fluid reservoir of rear brake	M5	5 Nm (3.7 lbf ft)	Loctite® 243™
Screw, brake line holder	M5	5 Nm (3.7 lbf ft)	–
Screw, chain sliding piece	M5	5 Nm (3.7 lbf ft)	–
Screw, chain guard	M5	5 Nm (3.7 lbf ft)	–
Screw, fuel level indicator	M5	3 Nm (2.2 lbf ft)	–
Screw, fuel tank guard	M5x17	3 Nm (2.2 lbf ft)	–
Screw, steering damper fixing bracket	M5	5 Nm (3.7 lbf ft)	Loctite® 243™
Remaining chassis screws	M5	5 Nm (3.7 lbf ft)	–
Remaining chassis nuts	M6	15 Nm (11.1 lbf ft)	–
Screw, exhaust heat shield	M6	15 Nm (11.1 lbf ft)	–
Screw, exhaust clamp	M6	8 Nm (5.9 lbf ft)	–
Screw, foot brake pedal	M6	15 Nm (11.1 lbf ft)	Loctite® 243™
Screw, footbrake pedal stub	M6	10 Nm (7.4 lbf ft)	Loctite® 243™
Screw, footbrake cylinder	M6	10 Nm (7.4 lbf ft)	Loctite® 243™
Screw, fuel pump	M6	6 Nm (4.4 lbf ft)	–
Screw, shift lever stub	M6	10 Nm (7.4 lbf ft)	Loctite® 243™
Screw, shift rod	M6	12 Nm (8.9 lbf ft)	Loctite® 243™
Screw, shift shaft deflector on chain securing guide	M6	10 Nm (7.4 lbf ft)	Loctite® 243™
Screw, shift shaft deflector on shift shaft	M6	18 Nm (13.3 lbf ft)	Loctite® 243™
Remaining chassis screws	M6	10 Nm (7.4 lbf ft)	–
Remaining chassis nuts	M8	30 Nm (22.1 lbf ft)	–
Nut, forked bracket on footbrake pedal	M8	30 Nm (22.1 lbf ft)	Loctite® 243™
Screw, rear brake disc	M8	30 Nm (22.1 lbf ft)	Loctite® 243™
Screw, front brake disc	M8	30 Nm (22.1 lbf ft)	Loctite® 243™
Screw of rear brake caliper	M8	22 Nm (16.2 lbf ft)	Loctite® 243™
Screw, spring holder on side stand bracket	M8	15 Nm (11.1 lbf ft)	Loctite® 243™
Screw, rear footrest bracket	M8	25 Nm (18.4 lbf ft)	–
Screw, front footrest bracket	M8	25 Nm (18.4 lbf ft)	Loctite® 243™
Screw, top triple clamp	M8	17 Nm (12.5 lbf ft)	–
Screw, bottom triple clamp	M8	15 Nm (11.1 lbf ft)	–
Screw, fork stub	M8	15 Nm (11.1 lbf ft)	–
Screw, steering stem	M8	20 Nm (14.8 lbf ft)	–
Screw, handlebar stub	M8	20 Nm (14.8 lbf ft)	–
Screw, steering damper fixing bracket	M8	20 Nm (14.8 lbf ft)	Loctite® 243™
Screw, steering damper clamp on console	M8	20 Nm (14.8 lbf ft)	Loctite® 243™
Screw, work stand adapter	M8	25 Nm (18.4 lbf ft)	Loctite® 243™
Screw, subframe	M8	25 Nm (18.4 lbf ft)	Loctite® 243™
Screw, shift lever	M8	25 Nm (18.4 lbf ft)	Loctite® 243™
Screw, side stand bracket	M8	25 Nm (18.4 lbf ft)	Loctite® 243™
Screw, ignition lock (ratchet screw)	M8		Loctite® 243™
Remaining chassis screws	M8	25 Nm (18.4 lbf ft)	–
Remaining chassis nuts	M10	50 Nm (36.9 lbf ft)	–
Rear sprocket bolt	M10x1.25	50 Nm (36.9 lbf ft)	Loctite® 243™
Screw, front brake caliper	M10x1.25	45 Nm (33.2 lbf ft)	Loctite® 243™
Screw, shock absorber	M10	45 Nm (33.2 lbf ft)	Loctite® 243™
Screw, engine bearer	M10	45 Nm (33.2 lbf ft)	–

Screw, sidestand	M10	35 Nm (25.8 lbf ft)	Loctite® 243™
Screw, connecting lever, shock absorber deflector	M10	45 Nm (33.2 lbf ft)	Loctite® 243™
Remaining chassis screws	M10	45 Nm (33.2 lbf ft)	–
Nut of bell crank on frame	M14x1.5	100 Nm (73.8 lbf ft)	–
Lambda probe	M18x1.5	45 Nm (33.2 lbf ft)	–
Nut, swingarm pivot	M19x1.5	130 Nm (95.9 lbf ft)	Thread greased
Screw, seat lock	M22x1.5	8 Nm (5.9 lbf ft)	–
Nut, rear wheel spindle	M25x1.5	90 Nm (66.4 lbf ft)	Thread greased
Screw, front wheel spindle	M25x1.5	45 Nm (33.2 lbf ft)	–
Screw, steering head	M25x1.5	18 Nm (13.3 lbf ft)	–

Super unleaded (ROZ 95 / RON 95 / PON 91)

according to

- DIN EN 228 (ROZ 95 / RON 95 / PON 91)



3211398en



16.05.2008 Photo: Mitterbauer



KTM-Sportmotorcycle AG
5230 Mattighofen/Austria
<http://www.ktm.com>