

# CRATE CONTENTS LIST / SET UP INSTRUCTION

## 950 SUPERMOTO/990 SUPER DUKE 2006



Art.Nr.: 3.211.109 (Verpackung 5)

### CRATE CONTENTS LIST:

- 1 Motorcycle in state as shipped
- 1 Front spoiler (990 Super Duke only)
- 1 Handlebar
- Parts according to enclosed bypack list

### SET UP INSTRUCTIONS:



- Remove crate.
- Remove all of the packaged parts from the motorcycle and check the scope of supply (see above).
- Remove the protective film and unpack the handlebar.





- Cover the tank with the protective film to avoid any damage.
- Loosen the handlebar clamps and remove all control elements from the transport holder.

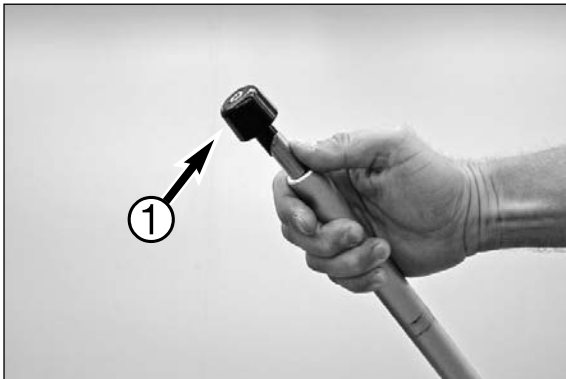

- Loosen the AH screw on the right end of the handlebar and remove the vibration absorber ❶.
- Slide the throttle grip on the handlebar, position the handlebar, slightly tighten the screws on the handlebar clamps.
- Mount the vibration absorber again, tighten the screws on the throttle grip.

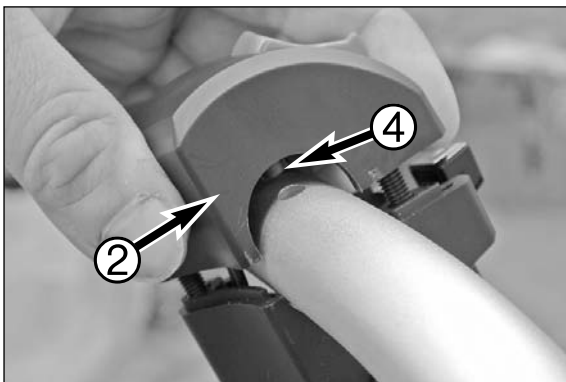

- Mount the flasher switch ❷ and the light switch ❸; the positioning pin ❹ on both switches must engage in a hole in the handlebar.

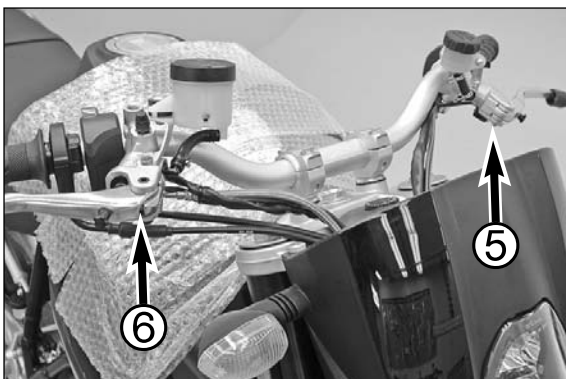
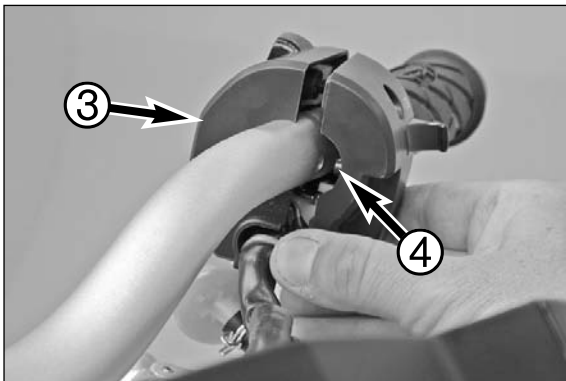

- Mount the clutch master cylinder ❺ and the hand brake cylinder ❻, apply Loctite 243 to the thread and tighten to 10 Nm.

NOTE: align the control elements and handlebar; run the hoses and wiring harnesses as illustrated.

- Tighten handlebar clamp to 20 Nm.

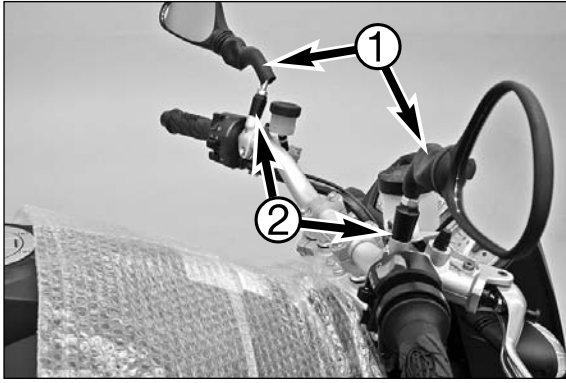

- Slide back the rubber protection ❶.
- Mount both mirror supports ❷ and the mirrors (left hand thread), tighten the nuts.
- Remove the cable ties from the foot rests.

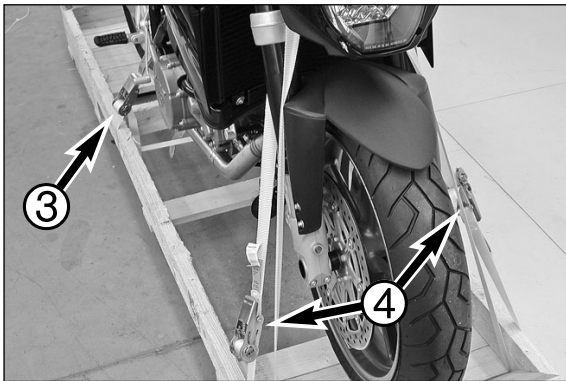

- Carefully loosen the rear tensioning strap ❸ and remove.
- Carefully relieve the front tensioning straps ❹ in steps and remove while holding the motorcycle handlebar.

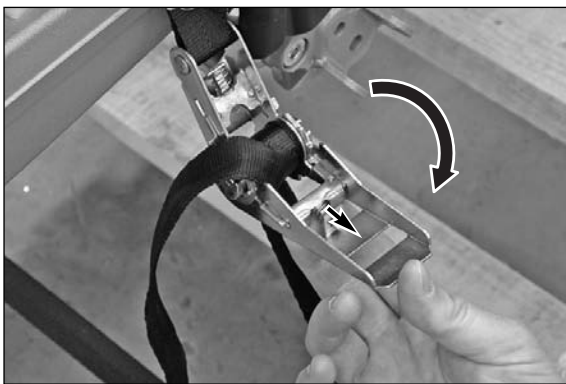

NOTE: to loosen the tensioning strap, first pull the lock towards the outside (away from the drum; small arrow) and then fold the handle down.

**! CAUTION !**

THE TENSION ON THE STRAP IS RELEASED AT ONCE, IT CANNOT BE GRADUALLY RELEASED.

- Have someone help you lift the motorcycle from the pallet.
- Remove the tank protector and the protective handlebar lever sleeves.



- Connect the connector ❺ to the starter relay (on the left side of the motor for the 990 Super Duke, under the seat for the 950 Supermoto).

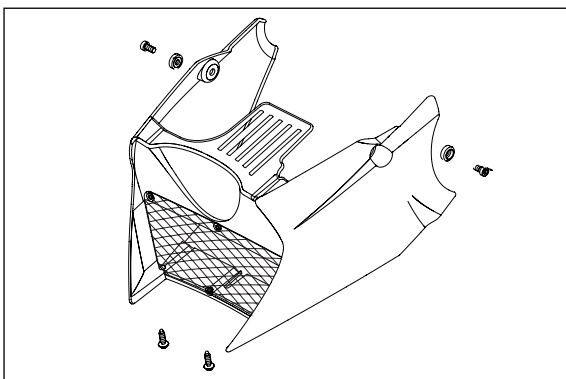

- Mount the front spoiler and screw on (990 Super Duke only).

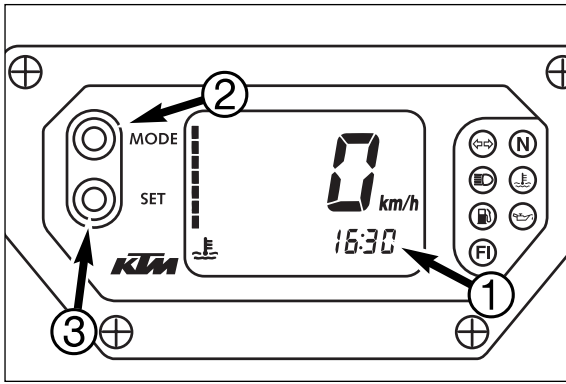

#### SET CLOCK

- Switch on the ignition and change to the CLOCK mode ❶ (using MODE button ❷).
- Simultaneously press MODE ❷ and SET ❸. The numbers on the clock will start to blink. Use the MODE button to set the hours and the SET button to set the minutes.
- Then press the MODE and SET buttons simultaneously.

NOTE: 0:00 will be displayed if the clock is not supplied with electricity. This can be caused by a defective fuse or a fault in the board electric system (see Troubleshooting).

#### PRE-DELIVERY INSPECTION

The current PDI is part of the delivery document. It must be printed from the dealer.net site and is an integral part of the motorcycle delivery.

### TIGHTENING TORQUES – CHASSIS

Collar bolt on front wheel spindle	M24x1.5	60 Nm
Collar nut wheel spindle rear	M25x1.5	90 Nm
AH bolt shock absorber top/bottom	M14x1.5	80 Nm
Collar nut for swing arm bolt	M19x1.5	130 Nm
Engine carrier bolts	M10	45 Nm
HH clamp bolts on top triple clamp (990 Super Duke)	M8	12 Nm
HH clamp bolts on top triple clamp (950 Supermoto)	M8	20 Nm
HH clamp bolts on bottom triple clamp	M8	15 Nm
HH screw for steering head	M20x1,5	12 Nm
HH clamp bolts on fork legs	M8	15 Nm
Collar bolts for handlebar clamps	M8	20 Nm
AH bolt for handlebar mount	M10	20 Nm
HH clamp bolts for steering stem	M8	20 Nm
HH bolts on handbrake cylinder	M6	10 Nm
Exhaust clamps for ball joint	M8	35 Nm
Other bolts on chassis	M6	10 Nm
	M8	25 Nm
	M10	45 Nm
Other collar nuts on chassis	M6	15 Nm
	M8	30 Nm
	M10	50 Nm